

**Title** : Q4 2017 PVS Management App Enhanced Functionality for Residential Commissioning, T17013  
**Date** : December 14, 2017  
**Author** : Dylan Benjamin, Residential Systems Senior Integration Manager  
**Application** : All residential PVS5x installations

---

## Commissioning Best Practices

- Use only Google Chrome OR Mozilla Firefox as your browser—*do not use Internet Explorer*.
- Always exit your browser completely after you finish the commissioning process.
- **Firmware (FW) updates:** If an update is *not* necessary, you'll see a message indicating that the FW is already up to date; if an update *is* necessary, you will see the progress bar working. After the update completes and the Management App brings you back to the commissioning start page, **it is critical that you either close out of your browser completely OR refresh the browser (F5 key)**.

## Overview

SunPower is announcing new features in the PVS Management App commissioning process:

- Shorter discovery times for Equinox™ systems
- An improved device configuration page that enables you to claim only the AC modules that are part of the system you installed
- Enhanced **help** button that provides quick support for Equinox installations: technical notifications, installation guides, and training materials are available by clicking the help button when you're in the PVS Management App.

**Important!** When you initiate the commissioning process, the system will automatically check whether there is a firmware update available. If an update is available, it will begin downloading and you will see the progress bar working. Wait for it to complete, and then click continue. The Management App will take you to the page where you choose residential or commercial. **After the firmware update, but before you click residential, refresh the page (press F5) and allow the page to refresh.**

### Discovery Settings Screen

A new feature called *Quick Discover* enables rapid discovery of Equinox devices (AC modules and internal meters):

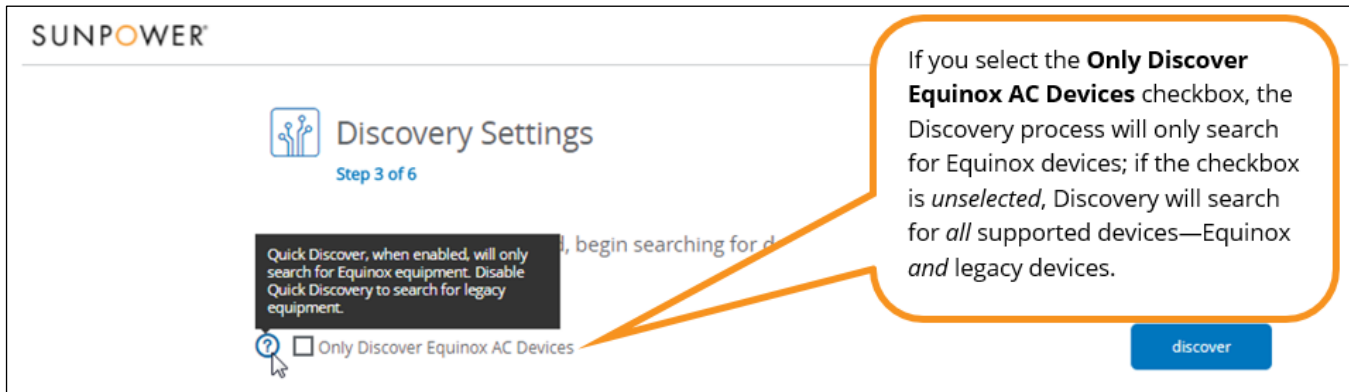

If you do not select the **Only Discover Equinox AC Devices** checkbox, the discovery process functions as it did prior to this enhancement—searching for and discovering all supported devices (AC modules, internal meters, external meters, and supported string inverters).

### Device Configuration

After discovery completes, you then configure the devices that were discovered:

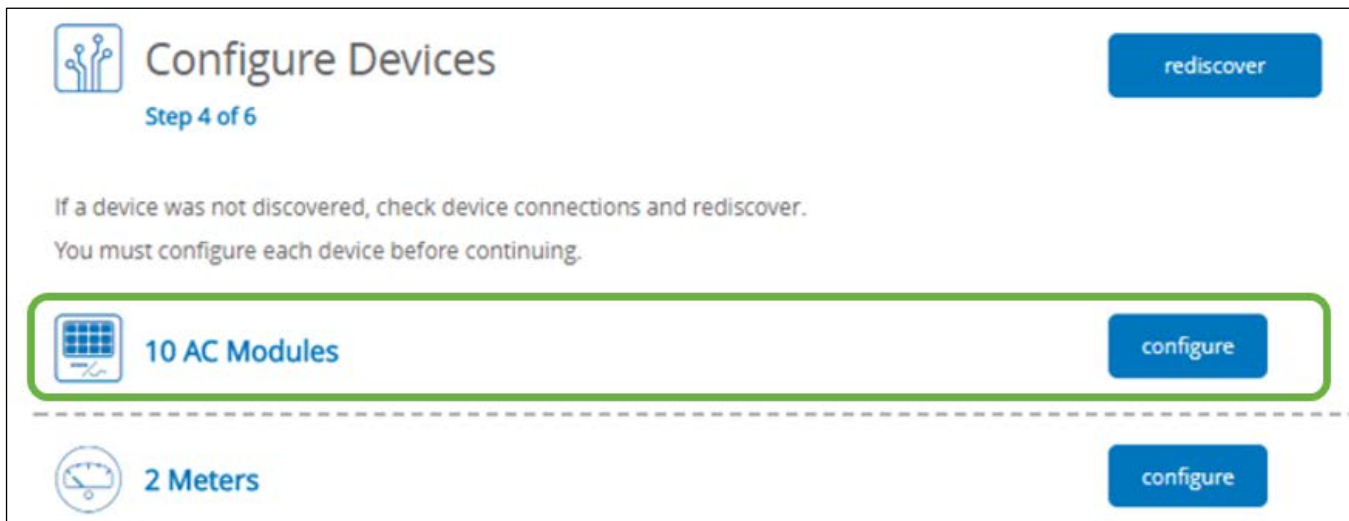

After you click **configure** in the AC Modules row, you must on the next screen verify that the **Serial Number** checkboxes are selected for **only** those AC modules which are installed at the site that you want to commission:

10 AC Modules

Grid Profile: California CPUC Rule21

Uncheck the AC modules that you did not install available at other sites, even if physically installed.

Total Discovered: 10

Serial Number	Module Type
<input checked="" type="checkbox"/>	AC Module
<input checked="" type="checkbox"/>	AC Module
<input checked="" type="checkbox"/>	AC Module
<input checked="" type="checkbox"/>	AC Module
<input checked="" type="checkbox"/>	AC Module
<input checked="" type="checkbox"/>	AC Module
<input checked="" type="checkbox"/>	AC Module
<input checked="" type="checkbox"/>	AC Module
<input checked="" type="checkbox"/>	AC Module
<input checked="" type="checkbox"/>	AC Module

back

done

Total Claimed: 10

**Other AC Modules**

The modules listed below are visible to this PVSS but are not available to claim. If a module you're attempting to commission is in the list below please contact SunPower support for assistance

Serial Number	Module Type
750051727012001	AC Module Type D
750051727012002	AC Module Type D
750051727012003	AC Module Type D
750051727012004	AC Module Type D
750051727012005	AC Module Type D

Refer to your array layout diagram and ensure that the serial number of each AC module that you installed appears in this column. The checkbox for each row in this column is selected by default. Before clicking the **done** button, you must ensure that you *clear* the checkbox of any row containing a serial number of an AC module that you did *not* install.

**Other AC Modules** are AC modules that were commissioned to a neighboring site and which became visible to your PVS during Discovery. Modules in this list cannot be claimed again—this information is provided to aid in troubleshooting with SunPower Technical Support.

Wait—how many did you install?

Improved functionality enables you to select and then claim *only those AC modules which truly belong to the array that you installed at the site:*

**10 AC Modules**

Grid Profile: California CPUC Rule21

Uncheck the AC modules that you did not install at this site. All checked AC modules will be claimed for this site and will not be available at other sites, even if physically installed elsewhere. Specify the model of each AC module.

Total Discovered: 10

Serial Number	Module Type	Model
<input checked="" type="checkbox"/> 750051730012001	AC Module Type D	SPR-E19-320-D-AC
<input checked="" type="checkbox"/> 750051730012005	AC Module Type D	SPR-E19-320-D-AC
<input checked="" type="checkbox"/> 750051730012006	AC Module Type D	SPR-E19-320-D-AC
<input checked="" type="checkbox"/> 750051730012002	AC Module Type D	SPR-E19-320-D-AC
<input checked="" type="checkbox"/> 750051730012003	AC Module Type D	SPR-E19-320-D-AC
<input checked="" type="checkbox"/> 750051730012004	AC Module Type D	SPR-E19-320-D-AC
<input checked="" type="checkbox"/> 750051730012007	AC Module Type D	SPR-E19-320-D-AC
<input checked="" type="checkbox"/> 750051730012008	AC Module Type D	SPR-E19-320-D-AC
<input type="checkbox"/> 750051730012009	AC Module Type D	SPR-E19-320-D-AC
<input type="checkbox"/> 750051730012010	AC Module Type D	SPR-E19-320-D-AC

Total Claimed: 8

done

Annotations:

- Green:** In this example, although Discovery found 10 AC modules, the installer knows to clear the last 2 checkboxes because the array layout diagram shows that the system has only the 8 AC modules whose serial numbers are selected here. (The 2 additional AC modules are very likely part of a neighbor's system that has yet to be commissioned.)
- Orange:** Enter the AC module **Model**, and then click the apply to all icon to apply that model number to each of the rows.
- Red:** "These 2 serial numbers are not in my array so I must clear these 2 checkboxes."
- Yellow:** You installed 8 so you claim only those 8.
- Purple:** If necessary, click the pencil icon to change the **Grid Profile** setting for the AC modules.

**8 AC Modules** displays here because you only left selected the checkboxes for the 8 installed serial numbers from your array layout diagram:

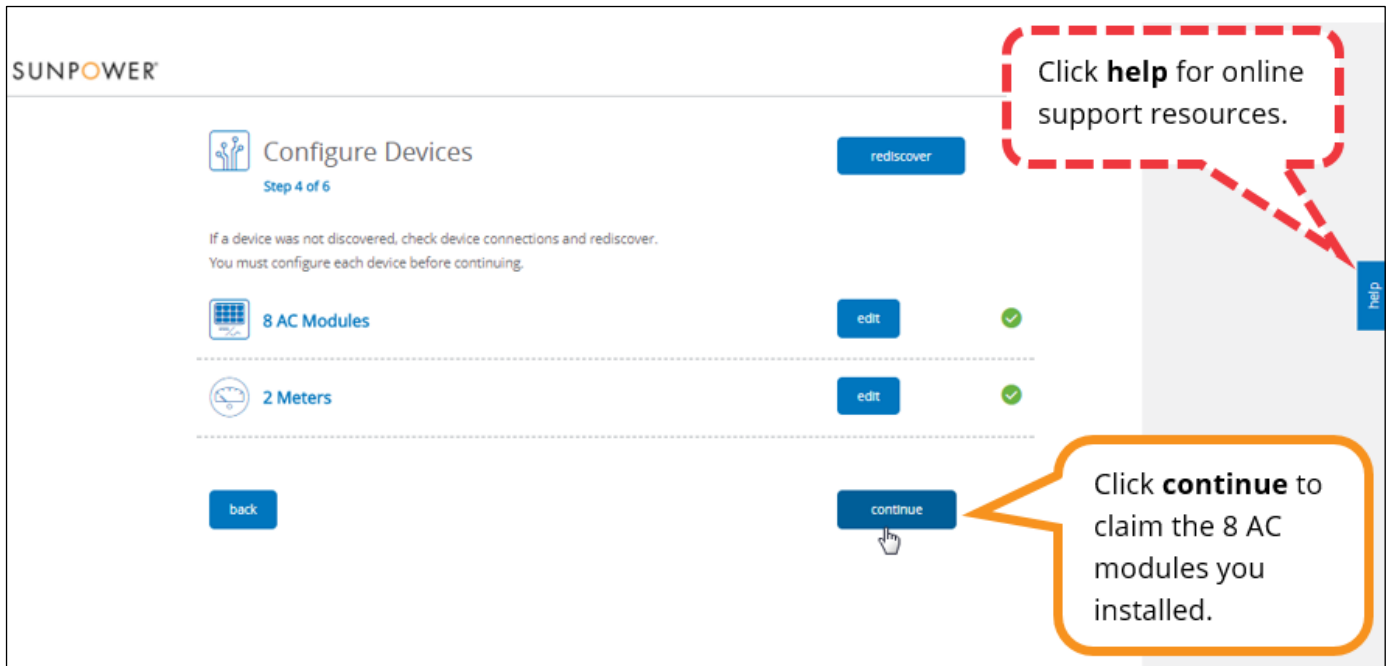

Click **continue** to claim the AC modules you configured, and then proceed with the commissioning flow as you normally would (verify device operations; create site; and module layout).

## Improved Help Access

The PV Supervisor Management App now includes a **help** button that links to the Equinox installation Support page: <https://us.sunpower.com/support/install/equinox>.



**Best Practice:** Bookmark the Equinox installation Support page!

The page enables quick access to support resources including installation guides, quick start guides, technical notifications, and training material. This link also appears in a mobile friendly page you can access while onsite. If you have questions during commissioning, use the **help** button first to quickly locate easy-to-use resources:

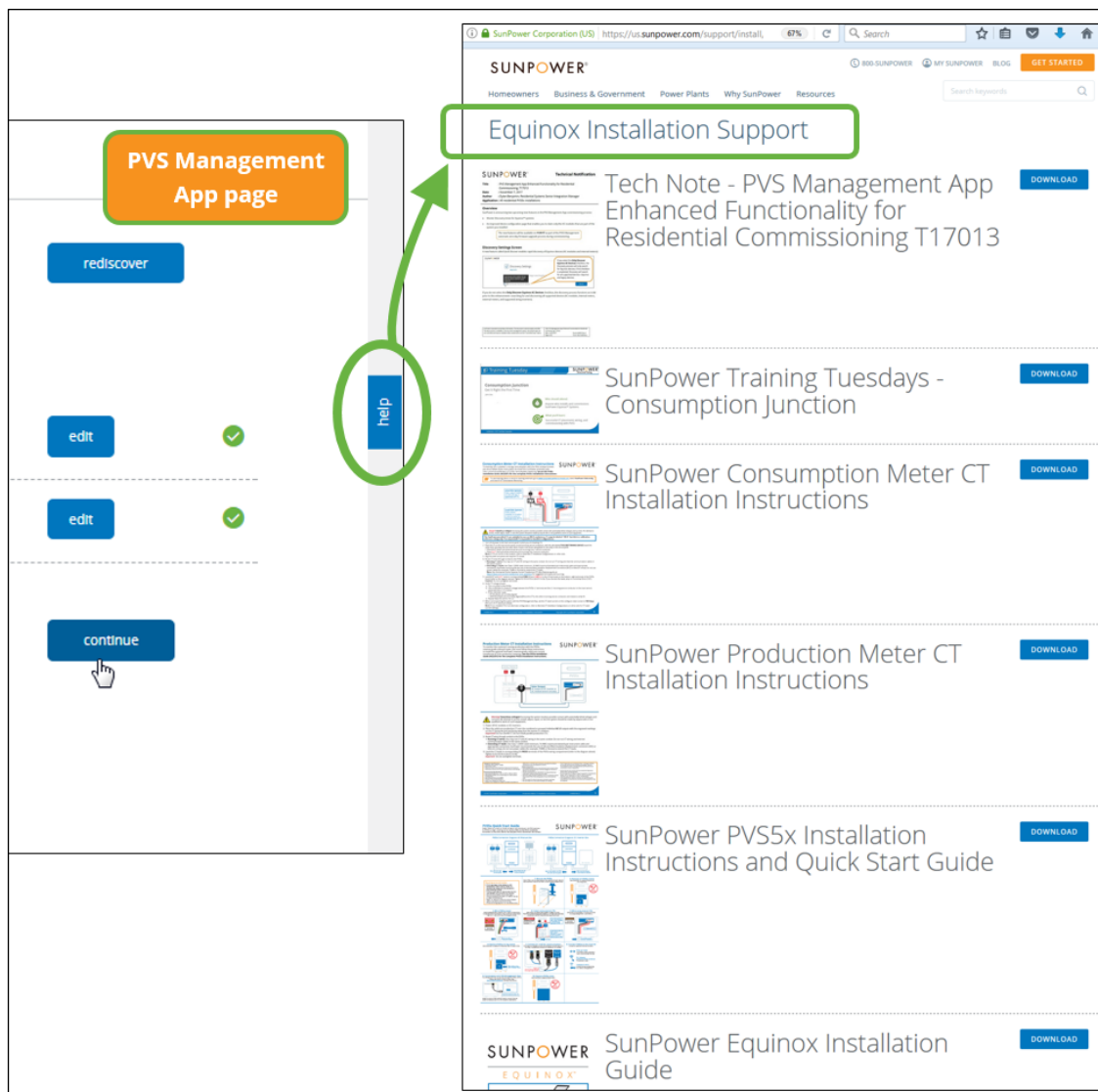

### Action Required

The PVS5x will automatically download an updated version of the PVS Management App that includes these updates when you connect your laptop to the PVS5x. You simply need to be aware of—and correctly execute—the new functionality.

### Result Expected

Installers will benefit from the new Equinox-only discovery feature because it will reduce the discovery time and provide an ability to select only those AC modules that they wish to commission. SunPower partners will also have easy access to Equinox guides and training material while in the field.

### Contacts

Phone		Email	
<b>US &amp; Australia</b>	1-855-977-7867	<b>US &amp; Australia</b>	<a href="mailto:technicalsupport@sunpower.com">technicalsupport@sunpower.com</a>
<b>Europe</b>	900 808068	<b>Spain</b>	<a href="mailto:soportetecnico@sunpowercorp.com">soportetecnico@sunpowercorp.com</a>
	0800-1812762	<b>Germany</b>	<a href="mailto:technischersupport@sunpowercorp.com">technischersupport@sunpowercorp.com</a>
	800 795 730	<b>Italy</b>	<a href="mailto:serviziotecnico@sunpowercorp.com">serviziotecnico@sunpowercorp.com</a>
	0 805 090 808	<b>France</b>	<a href="mailto:supporttechnique@sunpowercorp.com">supporttechnique@sunpowercorp.com</a>
	0800 786 35	<b>Belgium</b>	<a href="mailto:SunPowerBenelux.TechnischeDienst@sunpowercorp.com">SunPowerBenelux.TechnischeDienst@sunpowercorp.com</a>
	0800 023 39 80	<b>NL</b>	
	0808 281 8718	<b>UK</b>	<a href="mailto:techsupport.UK@sunpowercorp.com">techsupport.UK@sunpowercorp.com</a>
		<b>Asia Pacific</b>	<a href="mailto:SunPower_TechSupport@sunpower.com">SunPower_TechSupport@sunpower.com</a>